

## CHAPTER 5

# ◆◆ Flat Fan Nozzles

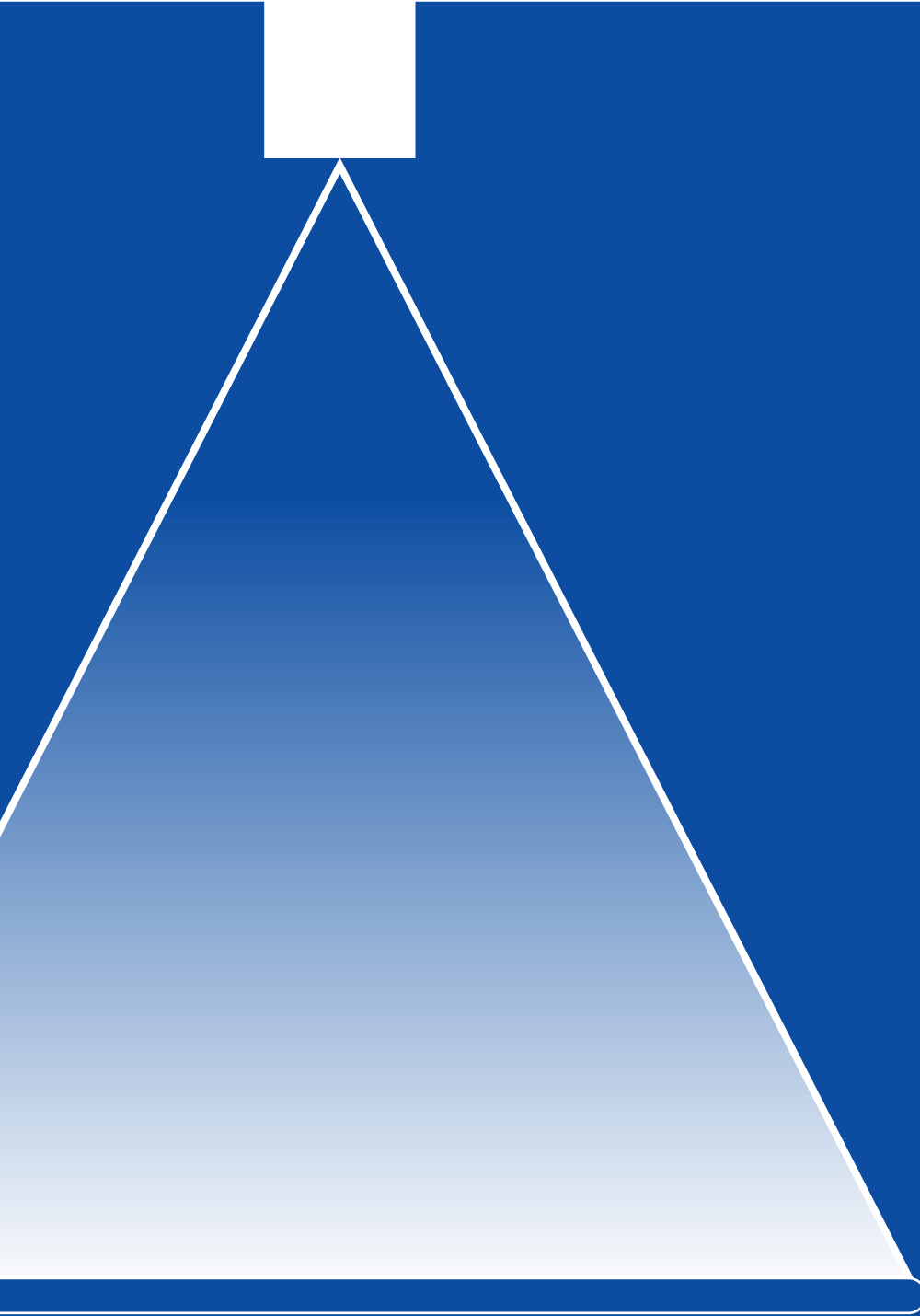

# ◆ ABOUT US

We Are Here to Help

---

## • Welcome to SPADFLOW

facing the **Challenges** of new industries and emerging markets.

## • Spray Technologies

with over **Thousands of Spray Nozzle Types** SPADFLOW has become Iran's leading producer.

## • From Design to Installation

with **Skilled** engineers and project managers, SPADFLOW is providing consultancy and support services.

## • Knowledge and Experience

as an **Expert** on spray technology, SPADFLOW is at the forefront of production and innovation.





# PRODUCT NUMBERS

## Everything You Need to Know

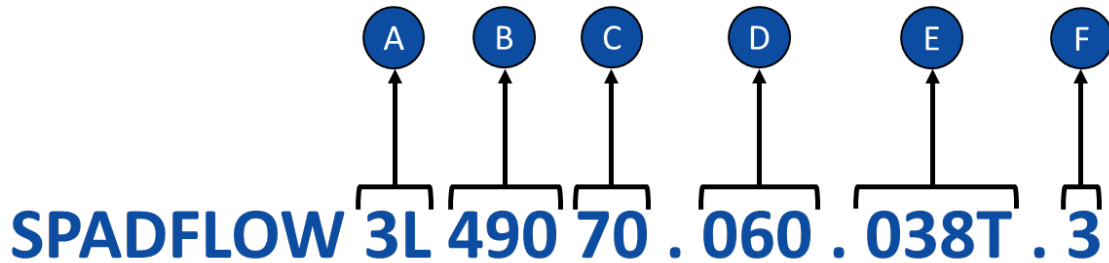

### A

#### Nozzle Type (Spray Pattern)

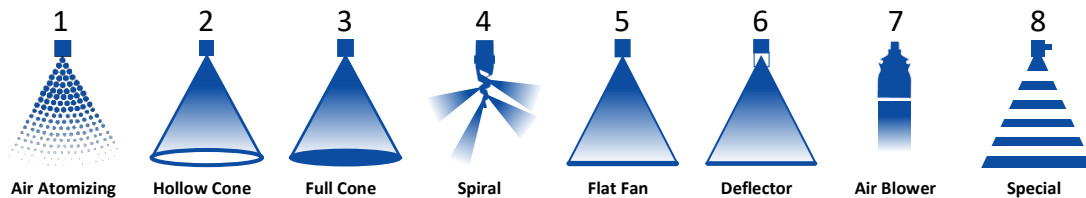

### B

#### Nozzle Series

### C

#### Flow Rate Rank

The flow rate rank is relative and depends on the respective nozzle type. The exact value is mentioned in tables on the product pages.

### D

#### Spray Angle

Theoretical spray angle is mentioned in tables on the product pages. Actual spray angle depends on installation and alignment.

- A = Theoretical Spray Angle
- D = Spray Distance
- C = theoretical Spray Coverage

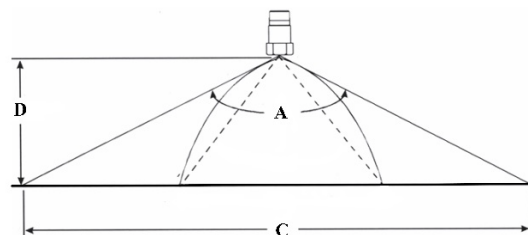

# PRODUCT NUMBERS

## Everything You Need to Know

### E

#### Connection

1/8" to 4" connections. The exact specification is mentioned in tables on the product pages.

T = BSBT Thread Type Connection

P = BSPP Thread Type Connection

N = NPT Thread Type Connection

R = Retaining Nut

### F

#### Material

Material	Code	Material	Code
Brass	1	Polyvinylchloride	PVC
AISI 304/304L Stainless Steel	2	Polypropylene	PP
AISI 316/316L Stainless Steel	3	Polyamide	PA
AISI 310 Stainless Steel	4	Polyvinylidene fluoride	PVDF
AISI 321 Stainless Steel	5	Polytetrafluorethylene	PTFE
AISI 420 Stainless Steel	6	Polyoxymethylene	POM
Tungsten Carbide	TN	Nitrile Butadiene Rubber	NBR
Phosphor Bronze	CuSn	Poly lactic Acid	PLA
Copper	Cu	Acrylonitrile Butadiene Styrene	ABS
Titanium	TI	Nylon Polyamide	PA6
Aluminum	AL	Polycarbonate	PC

#### Ø B (Equivalent Bore Diameter)

Applies to elliptical discharge holes of flat fan nozzles. A cylindrical hole with a diameter A has the same surface area as the ellipse.

#### Ø E (Narrowest Free Cross Section)

Important Characteristics for determining the pre-filtration of a nozzle. Can be less than a due to several swirl ducts.

Conversion Formula:  $K \text{ factor} \times \sqrt{P(\text{bar})} = Q (\text{l/min})$

All flow rate data in this catalogue is based on measurements with water,

Spray angle (α)	Code	Connection Size [inch]	Ø B [mm]	Ø E [mm]	Flow rate (Q) [l/min]						
					Pressure (P) [bar]						
					0.5	1.0	2.0	3.0	5.0	7.0	10.0
45°	3L 490 40 . 045	1/8"	1.25	1.25	0.57	0.76	1.00	1.18	1.44	1.65	1.90
	3L 490 60 . 045	1/4"	2.00	2.00	1.81	2.39	3.15	3.70	4.54	5.20	6.00
	3L 490 70 . 045	3/8"	2.65	2.65	3.22	4.24	5.60	6.59	8.08	9.24	10.66
	3L 490 78 . 045	1/2"	3.45	3.45	5.17	6.82	9.00	10.58	12.98	14.85	17.12
60°	3L 490 40 . 060	1/8"	1.15	1.15	0.57	0.76	1.00	1.18	1.44	1.65	1.90
	3L 490 80 . 060	3/8"	3.70	3.70	5.74	7.58	10.00	11.76	14.43	16.51	19.04
	3L 490 88 . 060	1/2"	4.65	4.65	9.19	12.13	16.00	18.82	23.08	26.41	30.46
	3L 490 96 . 060	3/4"	5.80	5.80	14.36	18.95	25.00	29.40	36.07	41.26	47.59
	3L 491 08 . 060	1"	8.15	8.15	28.72	37.89	50.00	58.80	72.14	82.53	95.18

SPADFLOW spray nozzles are manufactured with the highest precision and undergo permanent quality checks. However, production-related tolerances can affect the spray angle, flow rate, droplet size and droplet distribution.

# SPADFLOW 5B NF

## Widespread Flat-Fan Nozzle

Webpage  
+ STP

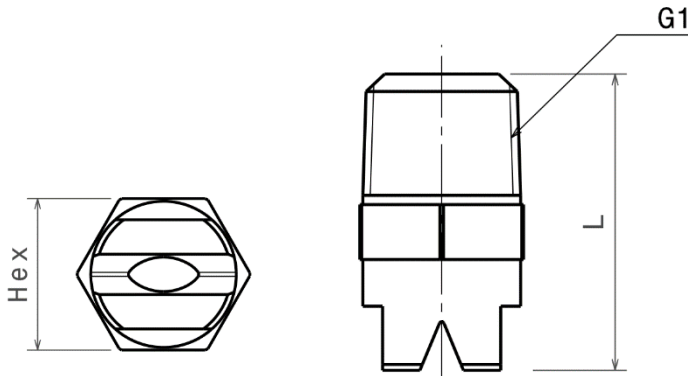

G1	Thread Type			Dimensions [mm]		Weight
	BSPT	BSPP	NPT	L	Hex	
1/8"	018T	018P	018N	22.2	11.1	28.4 gr
1/4"	014T	014P	014N	27.0	14.3	42.5 gr
3/8"	038T	038P	038N	31.8	17.5	56.7 gr
1/2"	012T	012P	012N	38.1	22.2	85.1 gr
3/4"	034T	034P	034N	44.5	28.6	170 gr
1"	100T	100P	100N	55.6	34.9	227 gr
1 1/4"	114T	114P	114N	63.5	44.5	340 gr
1 1/2"	112T	112P	112N	76.2	50.8	567 gr
2"	200T	200P	200N	88.9	63.5	1588 gr

Material*	Code
Brass	1
S.S.304	2
S.S.316	3

\* Different materials are available upon request

$\alpha$	Spray coverage @ 250 mm
15°	60 mm
30°	120 mm
50°	220 mm
65°	300 mm
80°	400 mm
90°	500 mm
110°	680 mm
120°	800 mm

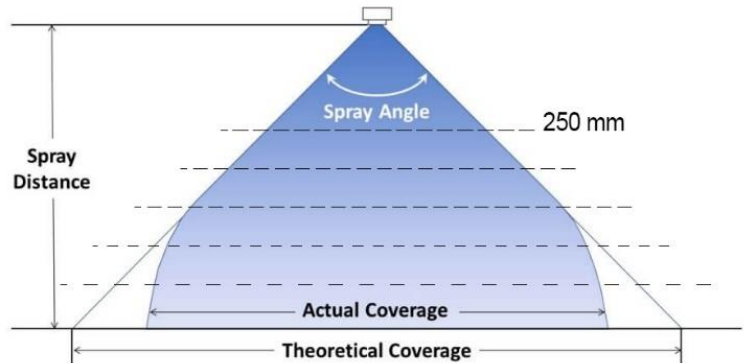

Spray angle ( $\alpha$ )	Code	Connection [inch]	A $\varnothing$ [mm]	Flow rate [l/min]							
				P [bar]							
				0.5	0.7	1.0 <i>K factor</i>	2.0	3.0	5.0	10	30
15°	5B NF01 . 015	1/8"-1/4"	0.66	0.16	0.19	<b>0.23</b>	0.32	0.39	0.51	0.72	1.25
	5B NF015 . 015	1/8"-1/4"	0.79	0.24	0.29	<b>0.34</b>	0.48	0.59	0.76	1.08	1.87
	5B NF02 . 015	1/8"-1/4"	0.91	0.32	0.38	<b>0.46</b>	0.64	0.79	1.02	1.44	2.49
	5B NF025 . 015	1/8"-1/4"	1.02	0.4	0.48	<b>0.57</b>	0.81	0.99	1.27	1.8	3.12
	5B NF03 . 015	1/8"-1/4"	1.09	0.48	0.57	<b>0.68</b>	0.97	1.18	1.53	2.16	3.74
	5B NF04 . 015	1/8"-1/4"	1.32	0.64	0.76	<b>0.91</b>	1.29	1.58	2.04	2.88	4.99
	5B NF05 . 015	1/8"-1/4"	1.45	0.81	0.95	<b>1.14</b>	1.61	1.97	2.55	3.6	6.24
	5B NF06 . 015	1/8"-1/4"	1.57	0.97	1.14	<b>1.37</b>	1.93	2.37	3.06	4.33	7.49
	5B NF08 . 015	1/8"-1/4"	1.83	1.28	1.52	<b>1.82</b>	2.57	3.15	4.06	5.74	9.95
	5B NF10 . 015	1/8"-1/4"-3/8"	2.03	1.61	1.91	<b>2.28</b>	3.22	3.95	5.1	7.21	12.5





# SPADFLOW 5B NF

## Widespread Flat-Fan Nozzle

Webpage  
+ STP

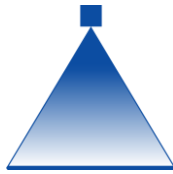

Spray angle (α)	Code	Connection [inch]	A Ø [mm]	Flow rate [l/min]							
				P [bar]							
				0.5	0.7	1.0 <i>K factor</i>	2.0	3.0	5.0	10	30
15°	5B NF15 . 015	1/8"-1/4"-3/8"	2.38	2.42	2.86	<b>3.42</b>	4.83	5.92	7.64	10.8	18.7
	5B NF20 . 015	1/8"-1/4"-3/8"	2.78	3.22	3.81	<b>4.56</b>	6.45	7.89	10.2	14.4	25
	5B NF30 . 015	1/8"-1/4"-3/8"	3.57	4.83	5.72	<b>6.84</b>	9.67	11.8	15.3	21.6	37.4
	5B NF40 . 015	1/8"-1/4"-3/8"	3.97	6.45	7.63	<b>9.12</b>	12.9	15.8	20.4	28.8	49.9
	5B NF50 . 015	1/4"-3/8"	4.37	8.06	9.53	<b>11.4</b>	16.1	19.7	25.5	36	62.4
	5B NF60 . 015	1/4"-3/8"-1/2"	4.76	9.67	11.4	<b>13.7</b>	19.3	23.7	30.6	43.2	74.9
	5B NF70 . 015	1/4"-3/8"-1/2"	5.16	11.3	13.3	<b>16</b>	22.6	27.6	35.7	50.4	87.4
	5B NF80 . 015	3/8"-1/2"	5.56	12.9	15.3	<b>18.2</b>	25.8	31.6	40.8	57.7	99.9
	5B NF90 . 015	3/8"-1/2"	5.95	14.5	17.2	<b>20.5</b>	29	35.5	45.9	64.9	112
	5B NF100 . 015	3/8"-1/2"	6.35	16.1	19.1	<b>22.8</b>	32.2	39.5	51	72.1	125
	5B NF120 . 015	3/8"-1/2"	6.75	19.3	22.9	<b>27.3</b>	38.7	47.4	61.1	86.5	150
	5B NF150 . 015	1/2"	7.54	24.2	28.6	<b>34.2</b>	48.3	59.2	76.4	108	187
	5B NF200 . 015	1/2"	8.73	32.2	38.1	<b>45.6</b>	64.5	78.9	102	144	250
	5B NF300 . 015	3/4"	10.7	48.3	57.2	<b>68.4</b>	96.7	118	153	216	374
	5B NF400 . 015	3/4"-1"	12.7	64.5	76.3	<b>91.2</b>	129	158	204	288	499
	5B NF750 . 015	1"	17.5	121	143	<b>171</b>	242	296	382	540	936
	5B NF800 . 015	1 1/4"	18.3	129	153	<b>182</b>	258	316	408	577	999
5B NF1150 . 015	1 1/4"	21.8	185	219	<b>262</b>	371	454	586	829	1440	
5B NF1500 . 015	1 1/2"	24.6	242	286	<b>342</b>	483	592	764	1080	1870	
5B NF2250 . 015	2"	30.2	362	429	<b>513</b>	725	890	1150	1620	2810	
30°	5B NF01 . 030	1/8"-1/4"	0.66	0.16	0.19	<b>0.23</b>	0.32	0.39	0.51	0.72	1.25
	5B NF015 . 030	1/8"-1/4"	0.79	0.24	0.29	<b>0.34</b>	0.48	0.59	0.76	1.08	1.87
	5B NF02 . 030	1/8"-1/4"	0.91	0.32	0.38	<b>0.46</b>	0.64	0.79	1.02	1.44	2.49
	5B NF025 . 030	1/8"-1/4"	1.02	0.4	0.48	<b>0.57</b>	0.81	0.99	1.27	1.8	3.12
	5B NF03 . 030	1/8"-1/4"	1.09	0.48	0.57	<b>0.68</b>	0.97	1.18	1.53	2.16	3.74
	5B NF04 . 030	1/8"-1/4"	1.32	0.64	0.76	<b>0.91</b>	1.29	1.58	2.04	2.88	4.99
	5B NF05 . 030	1/8"-1/4"	1.45	0.81	0.95	<b>1.14</b>	1.61	1.97	2.55	3.6	6.24
	5B NF06 . 030	1/8"-1/4"	1.57	0.97	1.14	<b>1.37</b>	1.93	2.37	3.06	4.33	7.49
	5B NF08 . 030	1/8"-1/4"	1.83	1.28	1.52	<b>1.82</b>	2.57	3.15	4.06	5.74	9.95
	5B NF10 . 030	1/8"-1/4"-3/8"	2.03	1.61	1.91	<b>2.28</b>	3.22	3.95	5.1	7.21	12.5
	5B NF15 . 030	1/8"-1/4"-3/8"	2.38	2.42	2.86	<b>3.42</b>	4.83	5.92	7.64	10.8	18.7
	5B NF20 . 030	1/8"-1/4"-3/8"	2.78	3.22	3.81	<b>4.56</b>	6.45	7.89	10.2	14.4	25
	5B NF30 . 030	1/8"-1/4"-3/8"	3.57	4.83	5.72	<b>6.84</b>	9.67	11.8	15.3	21.6	37.4
	5B NF40 . 030	1/8"-1/4"-3/8"	3.97	6.45	7.63	<b>9.12</b>	12.9	15.8	20.4	28.8	49.9
	5B NF50 . 030	1/4"-3/8"	4.37	8.06	9.53	<b>11.4</b>	16.1	19.7	25.5	36	62.4
	5B NF60 . 030	1/4"-3/8"-1/2"	4.76	9.67	11.4	<b>13.7</b>	19.3	23.7	30.6	43.2	74.9
	5B NF70 . 030	1/4"-3/8"-1/2"	5.16	11.3	13.3	<b>16</b>	22.6	27.6	35.7	50.4	87.4
	5B NF80 . 030	3/8"-1/2"	5.56	12.9	15.3	<b>18.2</b>	25.8	31.6	40.8	57.7	99.9
	5B NF90 . 030	3/8"-1/2"	5.95	14.5	17.2	<b>20.5</b>	29	35.5	45.9	64.9	112
	5B NF100 . 030	3/8"-1/2"	6.35	16.1	19.1	<b>22.8</b>	32.2	39.5	51	72.1	125
	5B NF120 . 030	3/8"-1/2"	6.75	19.3	22.9	<b>27.3</b>	38.7	47.4	61.1	86.5	150
	5B NF150 . 030	1/2"	7.54	24.2	28.6	<b>34.2</b>	48.3	59.2	76.4	108	187
	5B NF200 . 030	1/2"	8.73	32.2	38.1	<b>45.6</b>	64.5	78.9	102	144	250
	5B NF300 . 030	3/4"	10.7	48.3	57.2	<b>68.4</b>	96.7	118	153	216	374
	5B NF400 . 030	3/4"-1"	12.7	64.5	76.3	<b>91.2</b>	129	158	204	288	499
	5B NF750 . 030	1"	17.5	121	143	<b>171</b>	242	296	382	540	936
	5B NF800 . 030	1 1/4"	18.3	129	153	<b>182</b>	258	316	408	577	999
5B NF1150 . 030	1 1/4"	21.8	185	219	<b>262</b>	371	454	586	829	1440	
5B NF1500 . 030	1 1/2"	24.6	242	286	<b>342</b>	483	592	764	1080	1870	
5B NF2250 . 030	2"	30.2	362	429	<b>513</b>	725	890	1150	1620	2810	
50°	5B NF01 . 050	1/8"-1/4"	0.66	0.16	0.19	<b>0.23</b>	0.32	0.39	0.51	0.72	1.25
	5B NF015 . 050	1/8"-1/4"	0.79	0.24	0.29	<b>0.34</b>	0.48	0.59	0.76	1.08	1.87
	5B NF02 . 050	1/8"-1/4"	0.91	0.32	0.38	<b>0.46</b>	0.64	0.79	1.02	1.44	2.49
	5B NF025 . 050	1/8"-1/4"	1.02	0.4	0.48	<b>0.57</b>	0.81	0.99	1.27	1.8	3.12
	5B NF03 . 050	1/8"-1/4"	1.09	0.48	0.57	<b>0.68</b>	0.97	1.18	1.53	2.16	3.74
	5B NF04 . 050	1/8"-1/4"	1.32	0.64	0.76	<b>0.91</b>	1.29	1.58	2.04	2.88	4.99
	5B NF05 . 050	1/8"-1/4"	1.45	0.81	0.95	<b>1.14</b>	1.61	1.97	2.55	3.6	6.24
	5B NF06 . 050	1/8"-1/4"	1.57	0.97	1.14	<b>1.37</b>	1.93	2.37	3.06	4.33	7.49
	5B NF08 . 050	1/8"-1/4"	1.83	1.28	1.52	<b>1.82</b>	2.57	3.15	4.06	5.74	9.95
	5B NF10 . 050	1/8"-1/4"-3/8"	2.03	1.61	1.91	<b>2.28</b>	3.22	3.95	5.1	7.21	12.5



# SPADFLOW 5B NF

## Widespread Flat-Fan Nozzle

Webpage  
+ STP



Spray angle (α)	Code	Connection [inch]	A Ø [mm]	Flow rate [l/min]							
				P [bar]							
				0.5	0.7	1.0 <i>K factor</i>	2.0	3.0	5.0	10	30
50°	5B NF15 . 050	1/8"-1/4"-3/8"	2.38	2.42	2.86	<b>3.42</b>	4.83	5.92	7.64	10.8	18.7
	5B NF20 . 050	1/8"-1/4"-3/8"	2.78	3.22	3.81	<b>4.56</b>	6.45	7.89	10.2	14.4	25
	5B NF30 . 050	1/8"-1/4"-3/8"	3.57	4.83	5.72	<b>6.84</b>	9.67	11.8	15.3	21.6	37.4
	5B NF40 . 050	1/8"-1/4"-3/8"	3.97	6.45	7.63	<b>9.12</b>	12.9	15.8	20.4	28.8	49.9
	5B NF50 . 050	1/4"-3/8"	4.37	8.06	9.53	<b>11.4</b>	16.1	19.7	25.5	36	62.4
	5B NF60 . 050	1/4"-3/8"-1/2"	4.76	9.67	11.4	<b>13.7</b>	19.3	23.7	30.6	43.2	74.9
	5B NF70 . 050	1/4"-3/8"-1/2"	5.16	11.3	13.3	<b>16</b>	22.6	27.6	35.7	50.4	87.4
	5B NF80 . 050	3/8"-1/2"	5.56	12.9	15.3	<b>18.2</b>	25.8	31.6	40.8	57.7	99.9
	5B NF90 . 050	3/8"-1/2"	5.95	14.5	17.2	<b>20.5</b>	29	35.5	45.9	64.9	112
	5B NF100 . 050	3/8"-1/2"	6.35	16.1	19.1	<b>22.8</b>	32.2	39.5	51	72.1	125
	5B NF120 . 050	3/8"-1/2"	6.75	19.3	22.9	<b>27.3</b>	38.7	47.4	61.1	86.5	150
	5B NF150 . 050	1/2"	7.54	24.2	28.6	<b>34.2</b>	48.3	59.2	76.4	108	187
	5B NF200 . 050	1/2"	8.73	32.2	38.1	<b>45.6</b>	64.5	78.9	102	144	250
	5B NF300 . 050	3/4"	10.7	48.3	57.2	<b>68.4</b>	96.7	118	153	216	374
	5B NF400 . 050	3/4"-1"	12.7	64.5	76.3	<b>91.2</b>	129	158	204	288	499
	5B NF750 . 050	1"	17.5	121	143	<b>171</b>	242	296	382	540	936
	5B NF800 . 050	1 1/4"	18.3	129	153	<b>182</b>	258	316	408	577	999
	5B NF1150 . 050	1 1/4"	21.8	185	219	<b>262</b>	371	454	586	829	1440
5B NF1500 . 050	1 1/2"	24.6	242	286	<b>342</b>	483	592	764	1080	1870	
5B NF2250 . 050	2"	30.2	362	429	<b>513</b>	725	890	1150	1620	2810	
65°	5B NF01 . 065	1/8"-1/4"	0.66	0.16	0.19	<b>0.23</b>	0.32	0.39	0.51	0.72	1.25
	5B NF015 . 065	1/8"-1/4"	0.79	0.24	0.29	<b>0.34</b>	0.48	0.59	0.76	1.08	1.87
	5B NF02 . 065	1/8"-1/4"	0.91	0.32	0.38	<b>0.46</b>	0.64	0.79	1.02	1.44	2.49
	5B NF025 . 065	1/8"-1/4"	1.02	0.4	0.48	<b>0.57</b>	0.81	0.99	1.27	1.8	3.12
	5B NF03 . 065	1/8"-1/4"	1.09	0.48	0.57	<b>0.68</b>	0.97	1.18	1.53	2.16	3.74
	5B NF04 . 065	1/8"-1/4"	1.32	0.64	0.76	<b>0.91</b>	1.29	1.58	2.04	2.88	4.99
	5B NF05 . 065	1/8"-1/4"	1.45	0.81	0.95	<b>1.14</b>	1.61	1.97	2.55	3.6	6.24
	5B NF06 . 065	1/8"-1/4"	1.57	0.97	1.14	<b>1.37</b>	1.93	2.37	3.06	4.33	7.49
	5B NF08 . 065	1/8"-1/4"	1.83	1.28	1.52	<b>1.82</b>	2.57	3.15	4.06	5.74	9.95
	5B NF10 . 065	1/8"-1/4"-3/8"	2.03	1.61	1.91	<b>2.28</b>	3.22	3.95	5.1	7.21	12.5
	5B NF15 . 065	1/8"-1/4"-3/8"	2.38	2.42	2.86	<b>3.42</b>	4.83	5.92	7.64	10.8	18.7
	5B NF20 . 065	1/8"-1/4"-3/8"	2.78	3.22	3.81	<b>4.56</b>	6.45	7.89	10.2	14.4	25
	5B NF30 . 065	1/8"-1/4"-3/8"	3.57	4.83	5.72	<b>6.84</b>	9.67	11.8	15.3	21.6	37.4
	5B NF40 . 065	1/8"-1/4"-3/8"	3.97	6.45	7.63	<b>9.12</b>	12.9	15.8	20.4	28.8	49.9
	5B NF50 . 065	1/4"-3/8"	4.37	8.06	9.53	<b>11.4</b>	16.1	19.7	25.5	36	62.4
	5B NF60 . 065	1/4"-3/8"-1/2"	4.76	9.67	11.4	<b>13.7</b>	19.3	23.7	30.6	43.2	74.9
	5B NF70 . 065	1/4"-3/8"-1/2"	5.16	11.3	13.3	<b>16</b>	22.6	27.6	35.7	50.4	87.4
	5B NF80 . 065	3/8"-1/2"	5.56	12.9	15.3	<b>18.2</b>	25.8	31.6	40.8	57.7	99.9
	5B NF90 . 065	3/8"-1/2"	5.95	14.5	17.2	<b>20.5</b>	29	35.5	45.9	64.9	112
	5B NF100 . 065	3/8"-1/2"	6.35	16.1	19.1	<b>22.8</b>	32.2	39.5	51	72.1	125
	5B NF120 . 065	3/8"-1/2"	6.75	19.3	22.9	<b>27.3</b>	38.7	47.4	61.1	86.5	150
	5B NF150 . 065	1/2"	7.54	24.2	28.6	<b>34.2</b>	48.3	59.2	76.4	108	187
	5B NF200 . 065	1/2"	8.73	32.2	38.1	<b>45.6</b>	64.5	78.9	102	144	250
	5B NF300 . 065	3/4"	10.7	48.3	57.2	<b>68.4</b>	96.7	118	153	216	374
	5B NF400 . 065	3/4"-1"	12.7	64.5	76.3	<b>91.2</b>	129	158	204	288	499
	5B NF750 . 065	1"	17.5	121	143	<b>171</b>	242	296	382	540	936
	5B NF800 . 065	1 1/4"	18.3	129	153	<b>182</b>	258	316	408	577	999
	5B NF1150 . 065	1 1/4"	21.8	185	219	<b>262</b>	371	454	586	829	1440
5B NF1500 . 065	1 1/2"	24.6	242	286	<b>342</b>	483	592	764	1080	1870	
5B NF2250 . 065	2"	30.2	362	429	<b>513</b>	725	890	1150	1620	2810	
80°	5B NF01 . 080	1/8"-1/4"	0.66	0.16	0.19	<b>0.23</b>	0.32	0.39	0.51	0.72	1.25
	5B NF015 . 080	1/8"-1/4"	0.79	0.24	0.29	<b>0.34</b>	0.48	0.59	0.76	1.08	1.87
	5B NF02 . 080	1/8"-1/4"	0.91	0.32	0.38	<b>0.46</b>	0.64	0.79	1.02	1.44	2.49
	5B NF025 . 080	1/8"-1/4"	1.02	0.4	0.48	<b>0.57</b>	0.81	0.99	1.27	1.8	3.12
	5B NF03 . 080	1/8"-1/4"	1.09	0.48	0.57	<b>0.68</b>	0.97	1.18	1.53	2.16	3.74
	5B NF04 . 080	1/8"-1/4"	1.32	0.64	0.76	<b>0.91</b>	1.29	1.58	2.04	2.88	4.99
	5B NF05 . 080	1/8"-1/4"	1.45	0.81	0.95	<b>1.14</b>	1.61	1.97	2.55	3.6	6.24
	5B NF06 . 080	1/8"-1/4"	1.57	0.97	1.14	<b>1.37</b>	1.93	2.37	3.06	4.33	7.49
	5B NF08 . 080	1/8"-1/4"	1.83	1.28	1.52	<b>1.82</b>	2.57	3.15	4.06	5.74	9.95
	5B NF10 . 080	1/8"-1/4"-3/8"	2.03	1.61	1.91	<b>2.28</b>	3.22	3.95	5.1	7.21	12.5
	5B NF15 . 080	1/8"-1/4"-3/8"	2.38	2.42	2.86	<b>3.42</b>	4.83	5.92	7.64	10.8	18.7
	5B NF20 . 080	1/8"-1/4"-3/8"	2.78	3.22	3.81	<b>4.56</b>	6.45	7.89	10.2	14.4	25



# SPADFLOW 5B NF

## Widespread Flat-Fan Nozzle

Webpage  
+ STP



Spray angle (α)	Code	Connection [inch]	A Ø [mm]	Flow rate [l/min]							
				P [bar]							
				0.5	0.7	1.0 <i>K factor</i>	2.0	3.0	5.0	10	30
80°	5B NF30 . 080	1/8"-1/4"-3/8"	3.57	4.83	5.72	<b>6.84</b>	9.67	11.8	15.3	21.6	37.4
	5B NF40 . 080	1/8"-1/4"-3/8"	3.97	6.45	7.63	<b>9.12</b>	12.9	15.8	20.4	28.8	49.9
	5B NF50 . 080	1/4"-3/8"	4.37	8.06	9.53	<b>11.4</b>	16.1	19.7	25.5	36	62.4
	5B NF60 . 080	1/4"-3/8"-1/2"	4.76	9.67	11.4	<b>13.7</b>	19.3	23.7	30.6	43.2	74.9
	5B NF70 . 080	1/4"-3/8"-1/2"	5.16	11.3	13.3	<b>16</b>	22.6	27.6	35.7	50.4	87.4
	5B NF80 . 080	3/8"-1/2"	5.56	12.9	15.3	<b>18.2</b>	25.8	31.6	40.8	57.7	99.9
	5B NF90 . 080	3/8"-1/2"	5.95	14.5	17.2	<b>20.5</b>	29	35.5	45.9	64.9	112
	5B NF100 . 080	3/8"-1/2"	6.35	16.1	19.1	<b>22.8</b>	32.2	39.5	51	72.1	125
	5B NF120 . 080	3/8"-1/2"	6.75	19.3	22.9	<b>27.3</b>	38.7	47.4	61.1	86.5	150
	5B NF150 . 080	1/2"	7.54	24.2	28.6	<b>34.2</b>	48.3	59.2	76.4	108	187
	5B NF200 . 080	1/2"	8.73	32.2	38.1	<b>45.6</b>	64.5	78.9	102	144	250
	5B NF300 . 080	3/4"	10.7	48.3	57.2	<b>68.4</b>	96.7	118	153	216	374
	5B NF400 . 080	3/4"-1"	12.7	64.5	76.3	<b>91.2</b>	129	158	204	288	499
	5B NF750 . 080	1"	17.5	121	143	<b>171</b>	242	296	382	540	936
	5B NF800 . 080	1 1/4"	18.3	129	153	<b>182</b>	258	316	408	577	999
	5B NF1150 . 080	1 1/4"	21.8	185	219	<b>262</b>	371	454	586	829	1440
	5B NF1500 . 080	1 1/2"	24.6	242	286	<b>342</b>	483	592	764	1080	1870
	5B NF2250 . 080	2"	30.2	362	429	<b>513</b>	725	890	1150	1620	2810
90°	5B NF01 . 090	1/8"-1/4"	0.66	0.16	0.19	<b>0.23</b>	0.32	0.39	0.51	0.72	1.25
	5B NF015 . 090	1/8"-1/4"	0.79	0.24	0.29	<b>0.34</b>	0.48	0.59	0.76	1.08	1.87
	5B NF02 . 090	1/8"-1/4"	0.91	0.32	0.38	<b>0.46</b>	0.64	0.79	1.02	1.44	2.49
	5B NF025 . 090	1/8"-1/4"	1.02	0.4	0.48	<b>0.57</b>	0.81	0.99	1.27	1.8	3.12
	5B NF03 . 090	1/8"-1/4"	1.09	0.48	0.57	<b>0.68</b>	0.97	1.18	1.53	2.16	3.74
	5B NF04 . 090	1/8"-1/4"	1.32	0.64	0.76	<b>0.91</b>	1.29	1.58	2.04	2.88	4.99
	5B NF05 . 090	1/8"-1/4"	1.45	0.81	0.95	<b>1.14</b>	1.61	1.97	2.55	3.6	6.24
	5B NF06 . 090	1/8"-1/4"	1.57	0.97	1.14	<b>1.37</b>	1.93	2.37	3.06	4.33	7.49
	5B NF08 . 090	1/8"-1/4"	1.83	1.28	1.52	<b>1.82</b>	2.57	3.15	4.06	5.74	9.95
	5B NF10 . 090	1/8"-1/4"-3/8"	2.03	1.61	1.91	<b>2.28</b>	3.22	3.95	5.1	7.21	12.5
	5B NF15 . 090	1/8"-1/4"-3/8"	2.38	2.42	2.86	<b>3.42</b>	4.83	5.92	7.64	10.8	18.7
	5B NF20 . 090	1/8"-1/4"-3/8"	2.78	3.22	3.81	<b>4.56</b>	6.45	7.89	10.2	14.4	25
	5B NF30 . 090	1/8"-1/4"-3/8"	3.57	4.83	5.72	<b>6.84</b>	9.67	11.8	15.3	21.6	37.4
	5B NF40 . 090	1/8"-1/4"-3/8"	3.97	6.45	7.63	<b>9.12</b>	12.9	15.8	20.4	28.8	49.9
	5B NF50 . 090	1/4"-3/8"	4.37	8.06	9.53	<b>11.4</b>	16.1	19.7	25.5	36	62.4
	5B NF60 . 090	1/4"-3/8"-1/2"	4.76	9.67	11.4	<b>13.7</b>	19.3	23.7	30.6	43.2	74.9
	5B NF70 . 090	1/4"-3/8"-1/2"	5.16	11.3	13.3	<b>16</b>	22.6	27.6	35.7	50.4	87.4
	5B NF80 . 090	3/8"-1/2"	5.56	12.9	15.3	<b>18.2</b>	25.8	31.6	40.8	57.7	99.9
	5B NF90 . 090	3/8"-1/2"	5.95	14.5	17.2	<b>20.5</b>	29	35.5	45.9	64.9	112
	5B NF100 . 090	3/8"-1/2"	6.35	16.1	19.1	<b>22.8</b>	32.2	39.5	51	72.1	125
	5B NF120 . 090	3/8"-1/2"	6.75	19.3	22.9	<b>27.3</b>	38.7	47.4	61.1	86.5	150
	5B NF150 . 090	1/2"	7.54	24.2	28.6	<b>34.2</b>	48.3	59.2	76.4	108	187
	5B NF200 . 090	1/2"	8.73	32.2	38.1	<b>45.6</b>	64.5	78.9	102	144	250
	5B NF300 . 090	3/4"	10.7	48.3	57.2	<b>68.4</b>	96.7	118	153	216	374
	5B NF400 . 090	3/4"-1"	12.7	64.5	76.3	<b>91.2</b>	129	158	204	288	499
	5B NF750 . 090	1"	17.5	121	143	<b>171</b>	242	296	382	540	936
	5B NF800 . 090	1 1/4"	18.3	129	153	<b>182</b>	258	316	408	577	999
	5B NF1150 . 090	1 1/4"	21.8	185	219	<b>262</b>	371	454	586	829	1440
5B NF1500 . 090	1 1/2"	24.6	242	286	<b>342</b>	483	592	764	1080	1870	
5B NF2250 . 090	2"	30.2	362	429	<b>513</b>	725	890	1150	1620	2810	
110°	5B NF01 . 110	1/8"-1/4"	0.66	0.16	0.19	<b>0.23</b>	0.32	0.39	0.51	0.72	1.25
	5B NF015 . 110	1/8"-1/4"	0.79	0.24	0.29	<b>0.34</b>	0.48	0.59	0.76	1.08	1.87
	5B NF02 . 110	1/8"-1/4"	0.91	0.32	0.38	<b>0.46</b>	0.64	0.79	1.02	1.44	2.49
	5B NF025 . 110	1/8"-1/4"	1.02	0.4	0.48	<b>0.57</b>	0.81	0.99	1.27	1.8	3.12
	5B NF03 . 110	1/8"-1/4"	1.09	0.48	0.57	<b>0.68</b>	0.97	1.18	1.53	2.16	3.74
	5B NF04 . 110	1/8"-1/4"	1.32	0.64	0.76	<b>0.91</b>	1.29	1.58	2.04	2.88	4.99
	5B NF05 . 110	1/8"-1/4"	1.45	0.81	0.95	<b>1.14</b>	1.61	1.97	2.55	3.6	6.24
	5B NF06 . 110	1/8"-1/4"	1.57	0.97	1.14	<b>1.37</b>	1.93	2.37	3.06	4.33	7.49
	5B NF08 . 110	1/8"-1/4"	1.83	1.28	1.52	<b>1.82</b>	2.57	3.15	4.06	5.74	9.95
	5B NF10 . 110	1/8"-1/4"-3/8"	2.03	1.61	1.91	<b>2.28</b>	3.22	3.95	5.1	7.21	12.5
	5B NF15 . 110	1/8"-1/4"-3/8"	2.38	2.42	2.86	<b>3.42</b>	4.83	5.92	7.64	10.8	18.7
	5B NF20 . 110	1/8"-1/4"-3/8"	2.78	3.22	3.81	<b>4.56</b>	6.45	7.89	10.2	14.4	25
	5B NF30 . 110	1/8"-1/4"-3/8"	3.57	4.83	5.72	<b>6.84</b>	9.67	11.8	15.3	21.6	37.4
	5B NF40 . 110	1/8"-1/4"-3/8"	3.97	6.45	7.63	<b>9.12</b>	12.9	15.8	20.4	28.8	49.9





# SPADFLOW 5B NF

## Widespread Flat-Fan Nozzle

Webpage  
+ STP



Spray angle (α)	Code	Connection [inch]	A Ø [mm]	Flow rate [l/min]							
				P [bar]							
				0.5	0.7	1.0 <i>K factor</i>	2.0	3.0	5.0	10	30
110°	5B NF50 . 110	1/4"-3/8"	4.37	8.06	9.53	<b>11.4</b>	16.1	19.7	25.5	36	62.4
	5B NF60 . 110	1/4"-3/8"-1/2"	4.76	9.67	11.4	<b>13.7</b>	19.3	23.7	30.6	43.2	74.9
	5B NF70 . 110	1/4"-3/8"-1/2"	5.16	11.3	13.3	<b>16</b>	22.6	27.6	35.7	50.4	87.4
	5B NF80 . 110	3/8"-1/2"	5.56	12.9	15.3	<b>18.2</b>	25.8	31.6	40.8	57.7	99.9
	5B NF90 . 110	3/8"-1/2"	5.95	14.5	17.2	<b>20.5</b>	29	35.5	45.9	64.9	112
	5B NF100 . 110	3/8"-1/2"	6.35	16.1	19.1	<b>22.8</b>	32.2	39.5	51	72.1	125
	5B NF120 . 110	3/8"-1/2"	6.75	19.3	22.9	<b>27.3</b>	38.7	47.4	61.1	86.5	150
	5B NF150 . 110	1/2"	7.54	24.2	28.6	<b>34.2</b>	48.3	59.2	76.4	108	187
	5B NF200 . 110	1/2"	8.73	32.2	38.1	<b>45.6</b>	64.5	78.9	102	144	250
	5B NF300 . 110	3/4"	10.7	48.3	57.2	<b>68.4</b>	96.7	118	153	216	374
	5B NF400 . 110	3/4"-1"	12.7	64.5	76.3	<b>91.2</b>	129	158	204	288	499
	5B NF750 . 110	1"	17.5	121	143	<b>171</b>	242	296	382	540	936
	5B NF800 . 110	1 1/4"	18.3	129	153	<b>182</b>	258	316	408	577	999
	5B NF1150 . 110	1 1/4"	21.8	185	219	<b>262</b>	371	454	586	829	1440
	5B NF1500 . 110	1 1/2"	24.6	242	286	<b>342</b>	483	592	764	1080	1870
5B NF2250 . 110	2"	30.2	362	429	<b>513</b>	725	890	1150	1620	2810	
120°	5B NF01 . 120	1/8"-1/4"	0.66	0.16	0.19	<b>0.23</b>	0.32	0.39	0.51	0.72	1.25
	5B NF015 . 120	1/8"-1/4"	0.79	0.24	0.29	<b>0.34</b>	0.48	0.59	0.76	1.08	1.87
	5B NF02 . 120	1/8"-1/4"	0.91	0.32	0.38	<b>0.46</b>	0.64	0.79	1.02	1.44	2.49
	5B NF025 . 120	1/8"-1/4"	1.02	0.4	0.48	<b>0.57</b>	0.81	0.99	1.27	1.8	3.12
	5B NF03 . 120	1/8"-1/4"	1.09	0.48	0.57	<b>0.68</b>	0.97	1.18	1.53	2.16	3.74
	5B NF04 . 120	1/8"-1/4"	1.32	0.64	0.76	<b>0.91</b>	1.29	1.58	2.04	2.88	4.99
	5B NF05 . 120	1/8"-1/4"	1.45	0.81	0.95	<b>1.14</b>	1.61	1.97	2.55	3.6	6.24
	5B NF06 . 120	1/8"-1/4"	1.57	0.97	1.14	<b>1.37</b>	1.93	2.37	3.06	4.33	7.49
	5B NF08 . 120	1/8"-1/4"	1.83	1.28	1.52	<b>1.82</b>	2.57	3.15	4.06	5.74	9.95
	5B NF10 . 120	1/8"-1/4"-3/8"	2.03	1.61	1.91	<b>2.28</b>	3.22	3.95	5.1	7.21	12.5
	5B NF15 . 120	1/8"-1/4"-3/8"	2.38	2.42	2.86	<b>3.42</b>	4.83	5.92	7.64	10.8	18.7
	5B NF20 . 120	1/8"-1/4"-3/8"	2.78	3.22	3.81	<b>4.56</b>	6.45	7.89	10.2	14.4	25
	5B NF30 . 120	1/8"-1/4"-3/8"	3.57	4.83	5.72	<b>6.84</b>	9.67	11.8	15.3	21.6	37.4
	5B NF40 . 120	1/8"-1/4"-3/8"	3.97	6.45	7.63	<b>9.12</b>	12.9	15.8	20.4	28.8	49.9
	5B NF50 . 120	1/4"-3/8"	4.37	8.06	9.53	<b>11.4</b>	16.1	19.7	25.5	36	62.4
	5B NF60 . 120	1/4"-3/8"-1/2"	4.76	9.67	11.4	<b>13.7</b>	19.3	23.7	30.6	43.2	74.9
	5B NF70 . 120	1/4"-3/8"-1/2"	5.16	11.3	13.3	<b>16</b>	22.6	27.6	35.7	50.4	87.4
	5B NF80 . 120	3/8"-1/2"	5.56	12.9	15.3	<b>18.2</b>	25.8	31.6	40.8	57.7	99.9
	5B NF90 . 120	3/8"-1/2"	5.95	14.5	17.2	<b>20.5</b>	29	35.5	45.9	64.9	112
	5B NF100 . 120	3/8"-1/2"	6.35	16.1	19.1	<b>22.8</b>	32.2	39.5	51	72.1	125
	5B NF120 . 120	3/8"-1/2"	6.75	19.3	22.9	<b>27.3</b>	38.7	47.4	61.1	86.5	150
	5B NF150 . 120	3/4"	7.54	24.2	28.6	<b>34.2</b>	48.3	59.2	76.4	108	187
	5B NF200 . 120	3/4"	8.73	32.2	38.1	<b>45.6</b>	64.5	78.9	102	144	250
	5B NF300 . 120	3/4"	10.7	48.3	57.2	<b>68.4</b>	96.7	118	153	216	374
	5B NF400 . 120	3/4"-1"	12.7	64.5	76.3	<b>91.2</b>	129	158	204	288	499
	5B NF750 . 120	1"	17.5	121	143	<b>171</b>	242	296	382	540	936
	5B NF800 . 120	1 1/4"	18.3	129	153	<b>182</b>	258	316	408	577	999
	5B NF1150 . 120	1 1/4"	21.8	185	219	<b>262</b>	371	454	586	829	1440
5B NF1500 . 120	1 1/2"	24.6	242	286	<b>342</b>	483	592	764	1080	1870	
5B NF2250 . 120	2"	30.2	362	429	<b>513</b>	725	890	1150	1620	2810	